

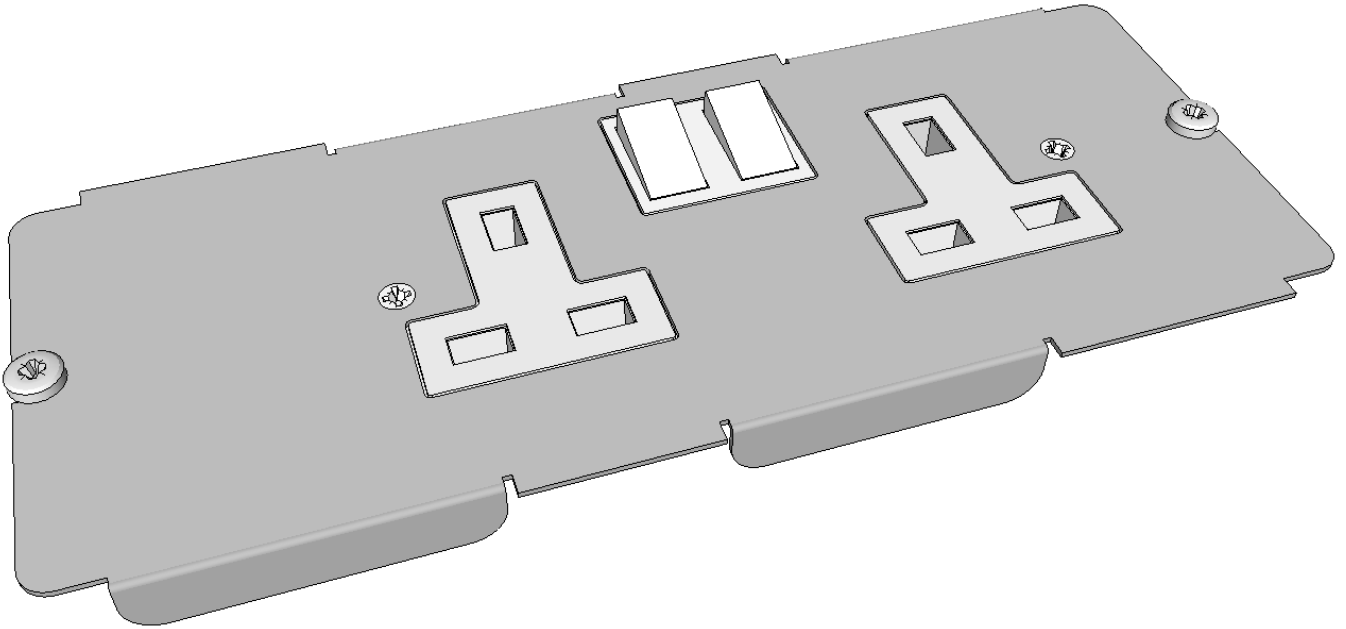

**CABLEDUCT**  
— LIMITED —



**OUTLET PLATE  
INSTALLATION &  
ORIENTATION  
Minima/700 Series**

OUTLET PLATE INSTALLATION & ORIENTATON

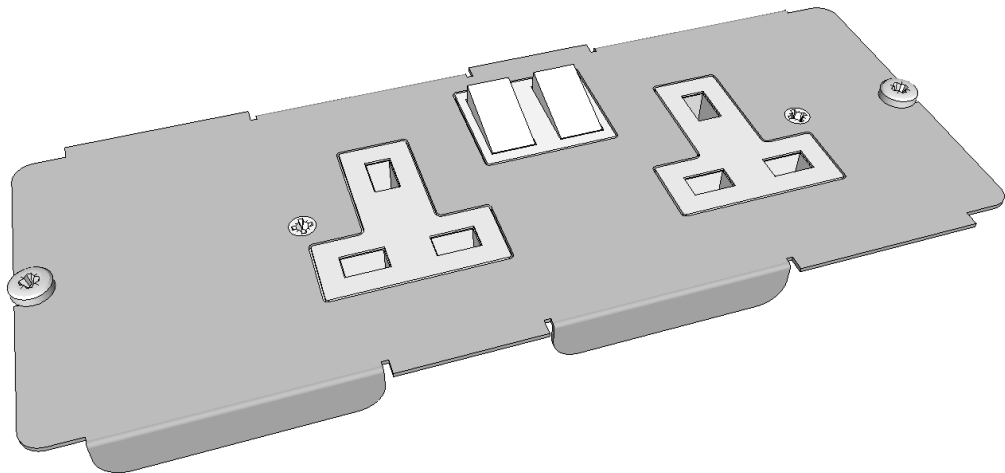
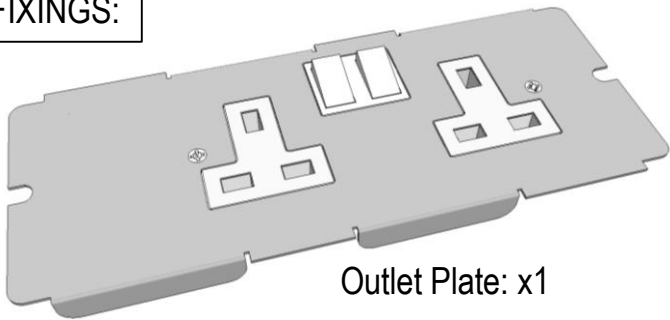

PLATE & FIXINGS:



Outlet Plate: x1



Pan Head Outlet Plate Screws: x2  
M5x6-PH

TOOLS NEEDED:

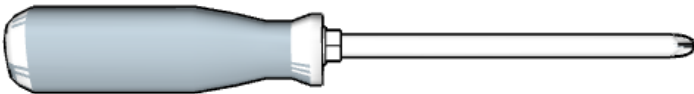

POWER/DATA CABLE FEED:

Conduit/Copex Feed

Trunking Feed

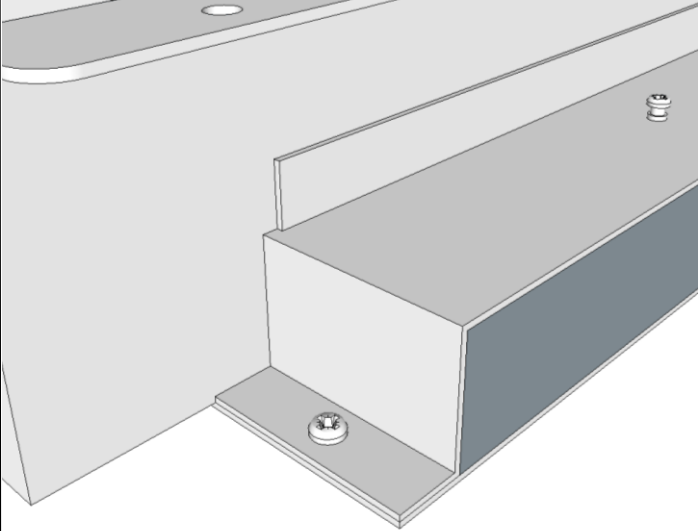
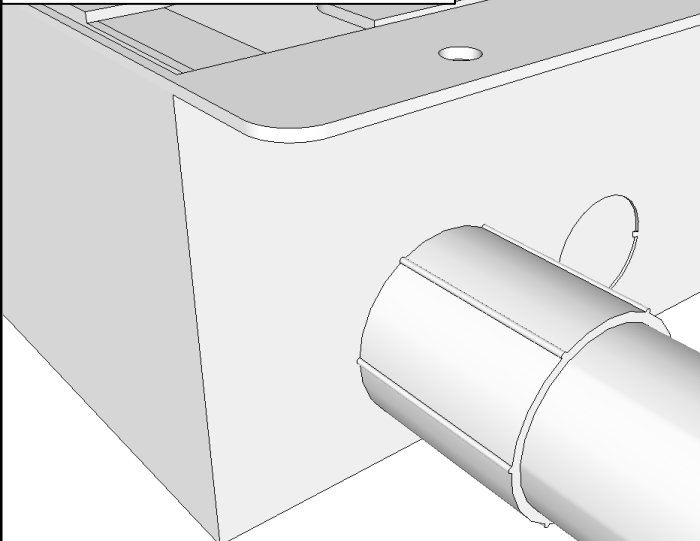

Feed power, data & AV cabling into base box via chosen cabling feed. Base boxes can accept power & data cabling via conduit/Copex or via trunking.

1

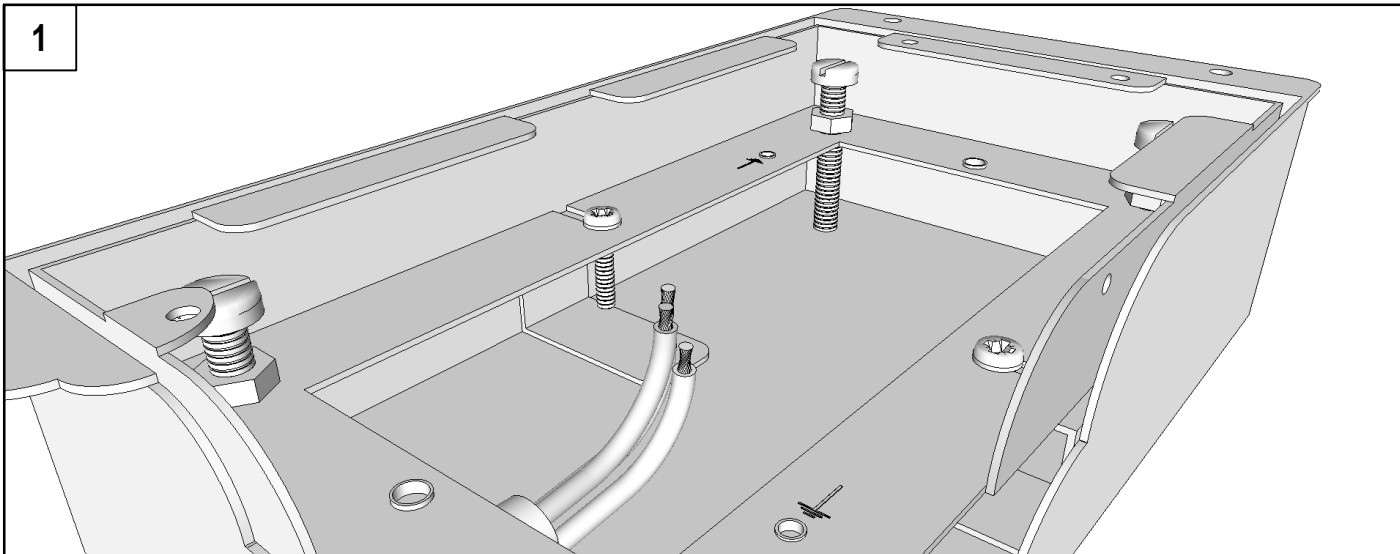

Once cables have been brought into the base box, wire the cables up to the underside of outlet plate.

**IMPORTANT:** Ensure power and data outlet plates are wired in by a professional and is in accordance with all necessary electrical wiring and data cabling regulations and guidelines.

2

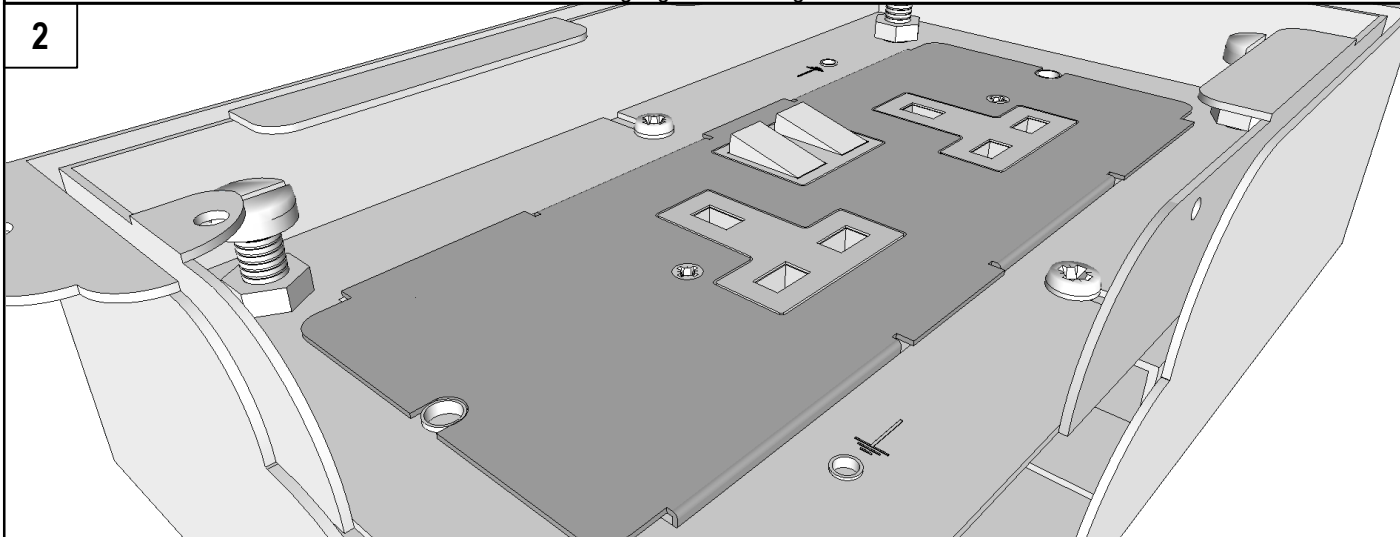

Once the outlet plate has been safely wired up correctly, align plate with compartment mounting holes located on adjustable inner frame.

3

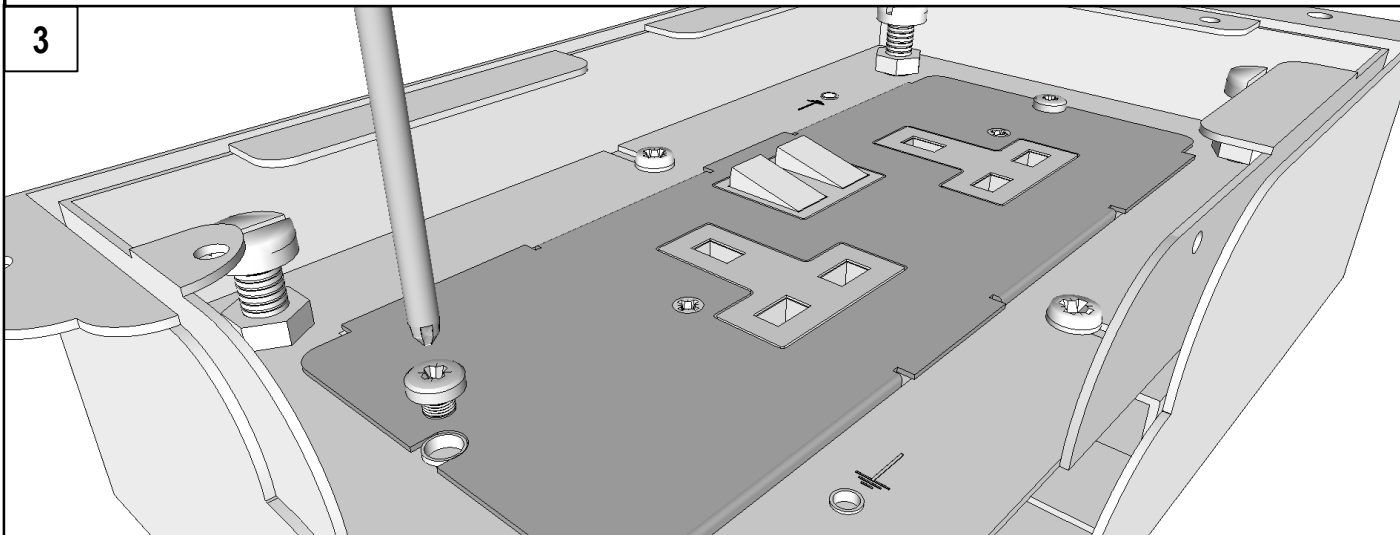

Using two domed M5x6-PH fixing screws supplied with each outlet plate, screw down plate ensuring securely fixed in place.

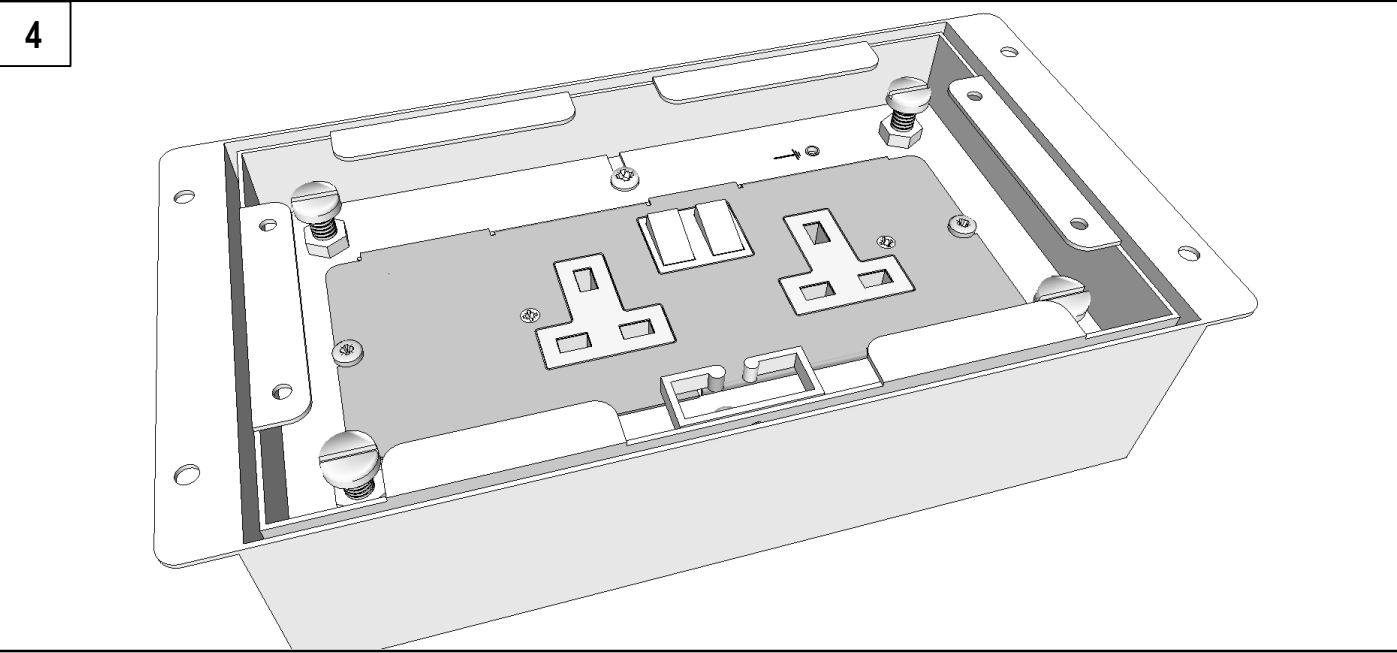

MULTIPLE POWER OUTLET PLATES ORIENTATON

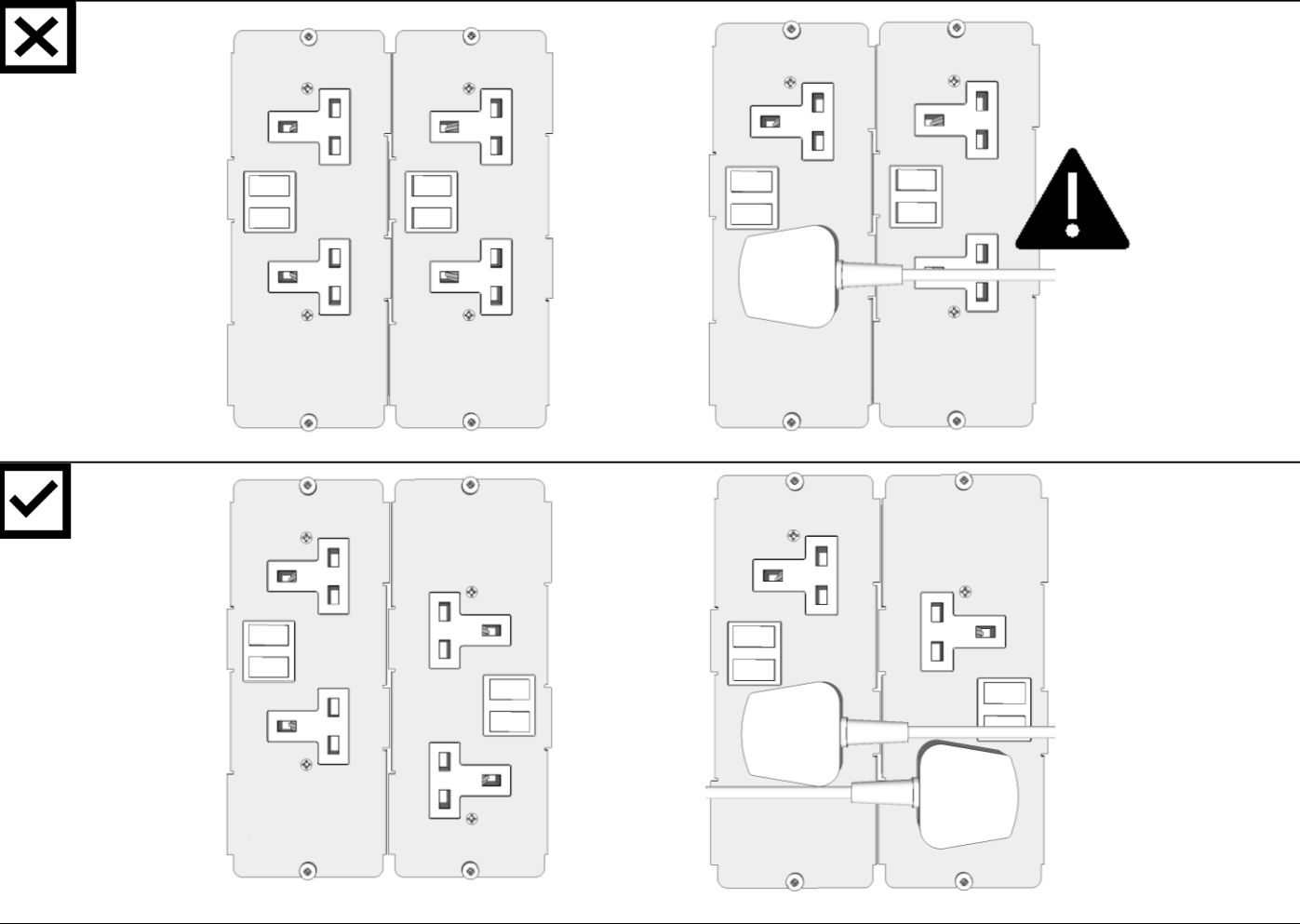

When installing more than one power outlet plate into a floor box, plate orientation needs to be considered to ensure plugs do not interfere from one socket to the next (**Top image**). To help avoid this issue, Cableduct recommends rotating the power outlet plates to stagger the positions of each plug socket (**Bottom image**).

1 Compartment:

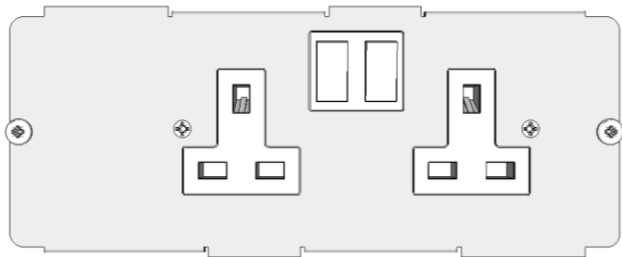

↓ CABLE GUIDE ↓

2 Compartments:

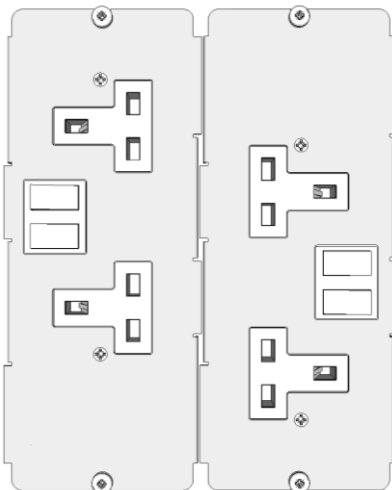

↓ CABLE GUIDE ↓

3 Compartments:

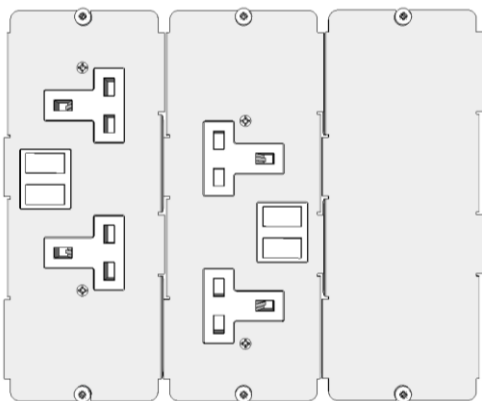

↓ CABLE GUIDE ↓

4 Compartments:

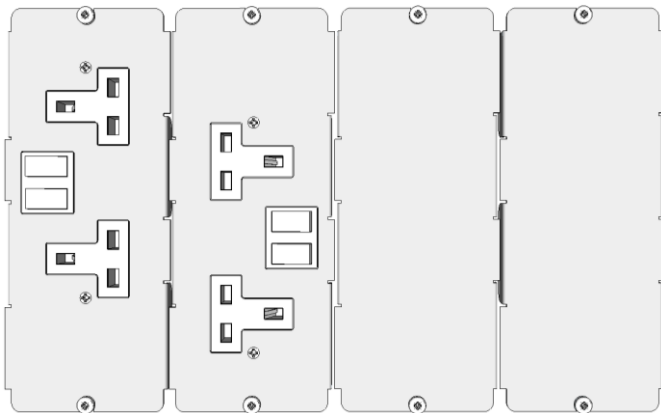

↓ CABLE GUIDE ↓

CONTACT US

-  [www.cableductuk.com](http://www.cableductuk.com)
-  [www.linkedin.com/cableduct-limited](http://www.linkedin.com/cableduct-limited)
-  @cableduct\_
-  @cableduct1
-  [www.pinterest.co.uk/Cableduct\\_UK](http://www.pinterest.co.uk/Cableduct_UK)

**Cableduct Limited**  
30 Selhurst Road,  
South Norwood,  
London, SE25 5QF

England, UK

T: +44 (0) 20 8683 1126  
F: +44 (0) 20 8689 7896  
E: [info@cableductuk.com](mailto:info@cableductuk.com)



 **SCAN ME**